

Type of Ballscrew	Rolled Ballscrew
Hand Screw	Right Hand Screw
Nominal Diameter	25
Lead	5
Optional Functions	None
Start Type for Nut	None
Nut Type	FSI
Self-lubrication	None
Number of Turns	T3: 3
Thread Length	271
Ball Diameter	3.175
Lead Deviation (mm/300mm)	C7
Screw End Machining I -Motor Side	BK17
Screw End Machining II -the Other Side	BK17
Total Length	400 mm

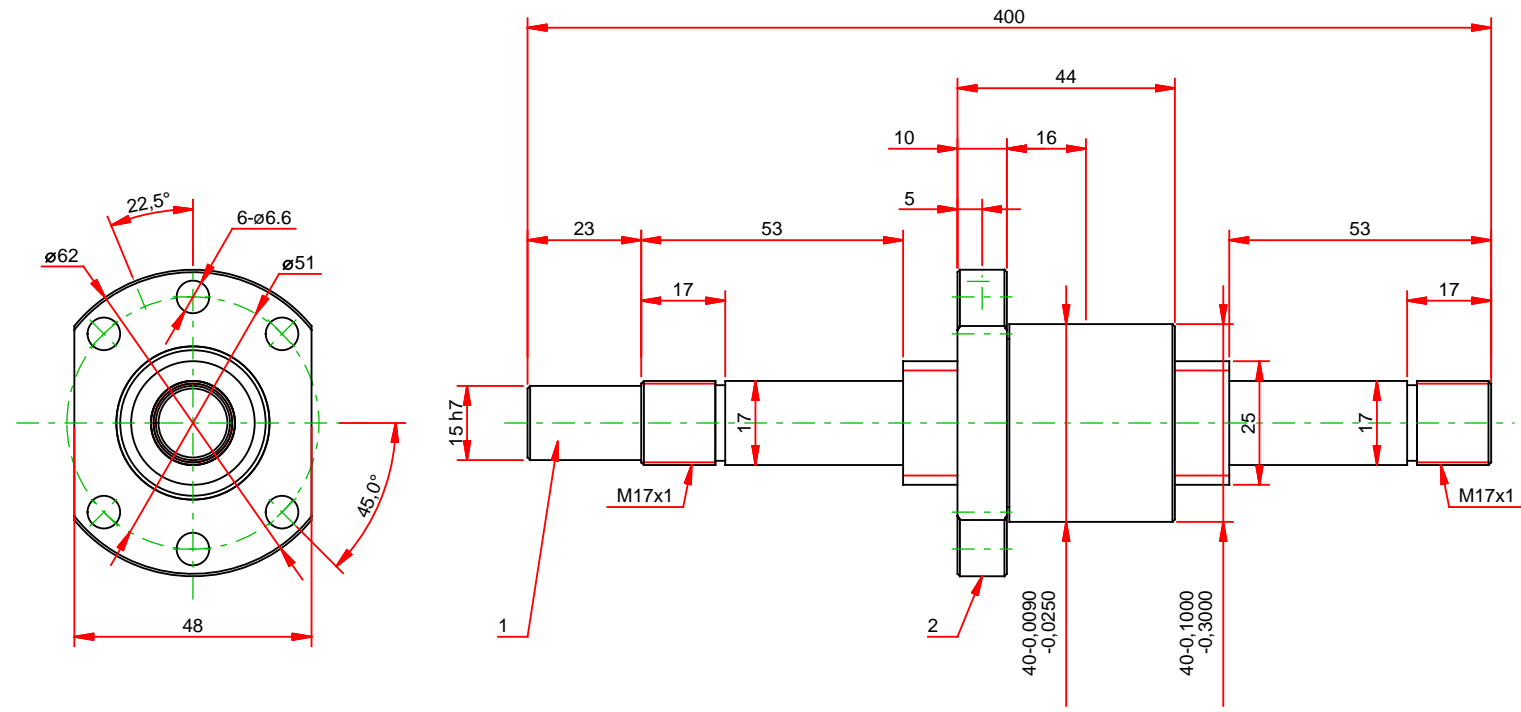

2	Ball Nut	1
1	Screw Shaft	1
No.	Part Name	Qty

Notes : - Drawing not to scale  
 - Dimensions subject to change

Part No. :  
 R25-5T3-FSIFW-271-400-0.05

Description :  
 Ball Screws - Main Configurator



**HIWIN**  
 Motion Control and System Technology

**Hiwin Technologies Corp.**

Taiwan:  
 Address : No. 7, Jingke Road  
 Taichung Precision Machinery Park  
 Taichung 40852, Taiwan  
 Tel. : +886-4-23594510  
 Email : business@hiwin.tw  
 Web : www.hiwin.tw

**Hiwin Corp.**

USA:  
 Address : 12455 Jim Dhamer Dr  
 Huntley, IL 60142  
 Tel. : +1-847-827-2270  
 Email : info@hiwin.com  
 Web : www.hiwin.com