

Type of Ballscrew	Rolled Ballscrew
Hand Screw	Right Hand Screw
Nominal Diameter	16
Lead	5
Optional Functions	None
Start Type for Nut	None
Nut Type	FSI
Self-lubrication	None
Number of Turns	T3: 3
Thread Length	313
Ball Diameter	3.175
Lead Deviation (mm/300mm)	C7
Screw End Machining I -Motor Side	BK12
Screw End Machining II -the Other Side	BK12
Total Length	400 mm

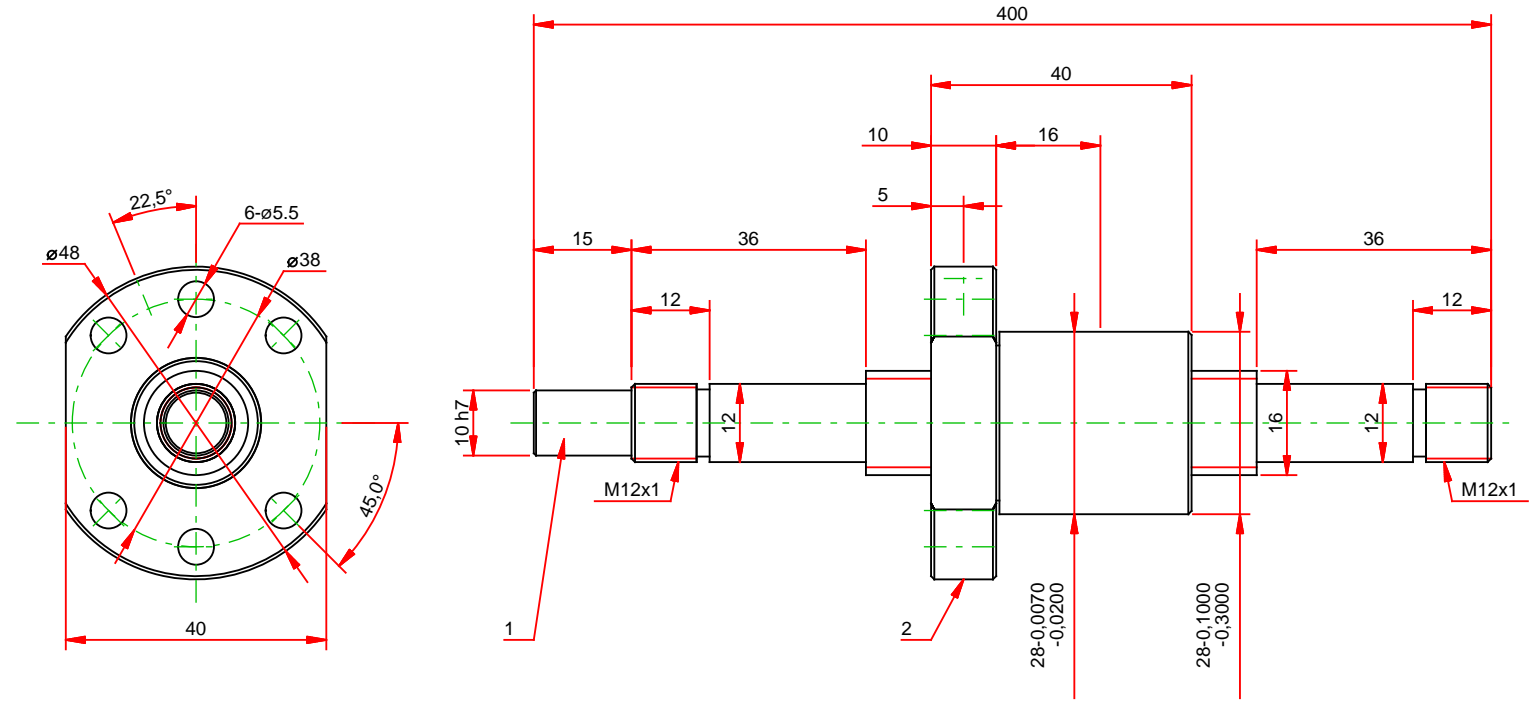

2	Ball Nut	1
1	Screw Shaft	1
No.	Part Name	Qty

Notes :
 - Drawing not to scale
 - Dimensions subject to change

Part No. :
 R16-5T3-FSIFW-313-400-0.05

Description :
 Ball Screws - Main Configurator



HIWIN
 Motion Control and System Technology

Hiwin Technologies Corp.
 Taiwan:
 Address : No. 7, Jingke Road
 Taichung Precision Machinery Park
 Taichung 40852, Taiwan
 Tel. : +886-4-23594510
 Email : business@hiwin.tw
 Web : www.hiwin.tw

Hiwin Corp.
 USA:
 Address : 12455 Jim Dhamer Dr
 Huntley, IL 60142
 Tel. : +1-847-827-2270
 Email : info@hiwin.com
 Web : www.hiwin.com